

Note: Measurements were not taken by LJT Surveying and we cannot guarantee their accuracy.

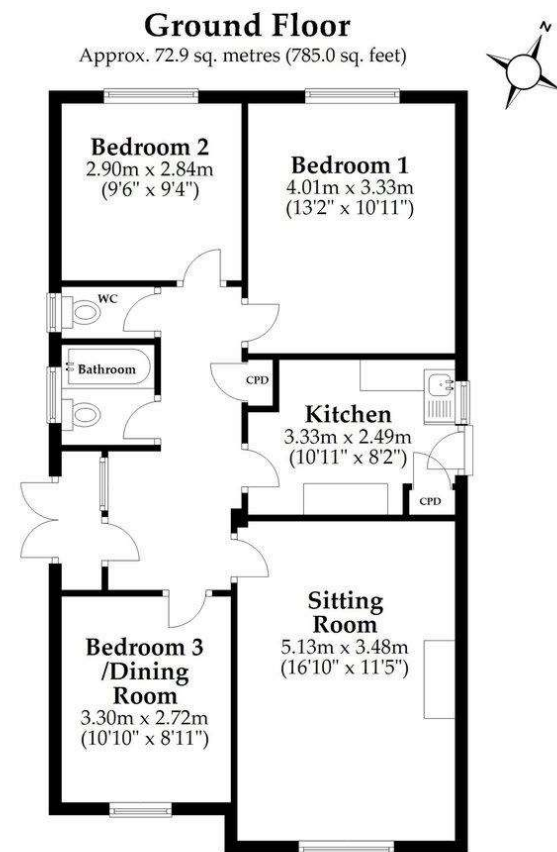

Total area: approx. 72.9 sq. metres (785.0 sq. feet)

This plan is not to scale and it is for general guidance only. LJT Surveying Ltd Ringwood



18 Square Close, Downton

Salisbury, Wiltshire SP5 3LQ

£369,950 Freehold

We are pleased to offer this three bedroom detached bungalow set in a sought after cul de sac location in Downton. The accommodation consists of; entrance hallway, lounge measuring 16'10" max x 11'5" max, kitchen, modern bathroom, separate w/c, three bedrooms, gardens to the front and rear, driveway leading to a detached garage. This property is being sold with no chain and viewing is essential.

IMPORTANT: We would like to inform prospective purchasers that these sales particulars have been prepared as a general guide only. A detailed survey has not been carried out, nor the services, appliances and fittings tested. Room sizes should not be relied upon for furnishing purposes and are approximate. If floorplans are included they are for guidance and illustration purposes only and may not be to scale. If there are any important matters likely to affect your decision to buy, please contact us before viewing the property.



Overview

- THREE BEDROOM
DETACHED
BUNGALOW
- CUL DE SAC
LOCATION
- SOLD WITH NO
CHAIN
- DOWNTON
LOCATION
- FRONT AND REAR
GARDENS
- DETACHED GARAGE
- GAS CENTRAL
HEATING
- VIEWING ESSENTIAL

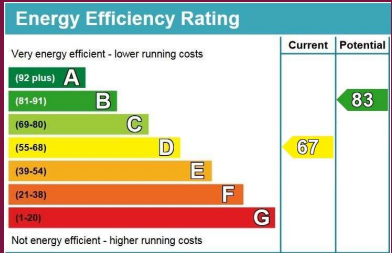

Entrance Hallway

Lounge 16'10" max x 11'5" max

Kitchen 10'11" max x 8'2" max

Bedroom One 13'2" max x 10'11" max

Bedroom Two 9'6" max x 9'4" max

Bedroom Three 10'10" max x 8'11" max

Bathroom

Separate W/C

Front and Rear Gardens

Detached Garage

Council Tax Band : D

Agents Note- Draft Copy of particulars

Disclaimer

These particulars are believed to be correct and have been verified by or on behalf of the Vendor. However, any interested party will satisfy themselves as to their accuracy and as to any other matter regarding the Property or its location or proximity to other features or facilities which is of specific importance to them. Distances and areas are only approximate and unless otherwise stated fixtures contents and fittings are not included in the sale. Prospective purchasers are always advised to commission a full inspection and structural survey of the Property before deciding to proceed with a purchase.